

1 TREE INVENTORY, REMOVALS, AND PROTECTION PLAN
SCALE: 1:200

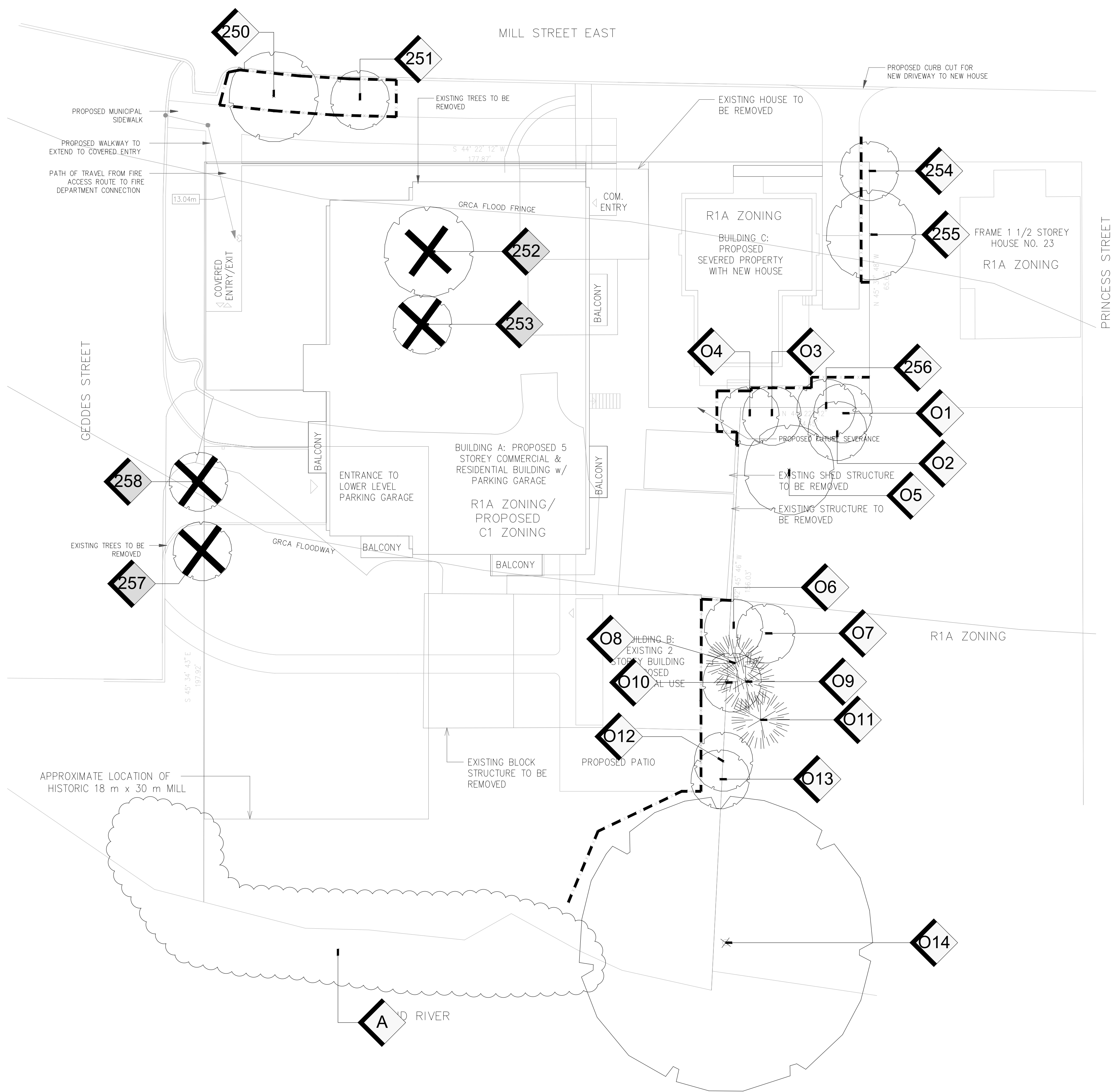

TREE INVENTORY NOTES

Tree #	Common Name	Botanical Name	DBH (CM)	Canopy (m)	Condition	Structure	Comments	Recommendation
250	Norway Maple	Acer platanoides	58	13	F/G	F/G	Minor deadwood in canopy	Retain
251	Sugar Maple	Acer saccharum	40	8	F	F	Moderate deadwood in canopy	Retain
252	Norway Maple	Acer platanoides	56	14	F	P	Past major structural failure evident, moderate deadwood in canopy	Remove due to construction
253	Norway Maple	Acer platanoides	32	10	F/G	F/G	Damage at trunk is healing over	Remove due to construction
254	Black Walnut	Juglans nigra	39	11	F/G	P	Significant phototropic lean and bow in trunk	Retain
255	Manitoba Maple	Acer negundo	~55	16	F	P	2 stems, one stem has single off shoot and shows past significant failures	Retain
256	Manitoba Maple	Acer negundo	~40	16	F/G	F/P	Contorted form, volunteer tree	Retain
257	Manitoba Maple	Acer negundo	39	12	F/P	F	Canopy within overhead wires, sparse upper canopy	Remove due to construction
258	Manitoba Maple	Acer negundo	34	14	F/G	F	Co-dominant at 0.9 metres	Remove due to construction
O1	Black Locust	Robinia pseudoacacia	~24	8	F/G	F	High canopy	Retain
O2	Black Locust	Robinia pseudoacacia	~28	9	F/G	F	High canopy	Retain
O3	Black Locust	Robinia pseudoacacia	~32	9	F	F	Co-dominant at approximately 1.2 metres	Retain
O4	Black Locust	Robinia pseudoacacia	~34	11	F	F	Co-dominant at approximately 1.5 metres	Retain
O5	Norway Spruce	Picea abies	~55	~14	F/G	G		Retain
O6	Black Walnut	Juglans nigra	34	15	G	F/G		Retain
O7	Maidenhair Tree	Ginkgo biloba	~26	9	G	F/G		Retain
O8	Tamarack	Larix laricina	~20	N/A	D	P	Tree is 100% dead	Retain
O9	Tamarack	Larix laricina	~28	9	F	F		Retain
O10	Black Walnut	Juglans nigra	40	14	F/G	F	Moderate deadwood in canopy	Retain
O11	White Spruce	Picea glauca	~32	13	F	F	Moderate deadwood in canopy, multiple leaders	Retain
O12	Manitoba Maple	Acer negundo	~23	8	F/P	F/P	Significant deadwood in canopy	Retain
O13	Manitoba Maple	Acer negundo	~35	12	F	F	Co-dominant at 1.5 metres, minor deadwood in canopy	Retain
O14	Weeping Willow	Salix babylonica	~200	~24	F/P	P	Multiple stems, suspected internal rot, multiple past significant failures	Retain
A	Tree Grouping	-	-	-	-	-	2 Manitoba Maple at 1-10cm DBH, 4 Manitoba Maple and 1 Black Walnut at 11-20cm DBH, 2 Manitoba Maple and 2 Black Walnut at 21-30cm DBH	Retain

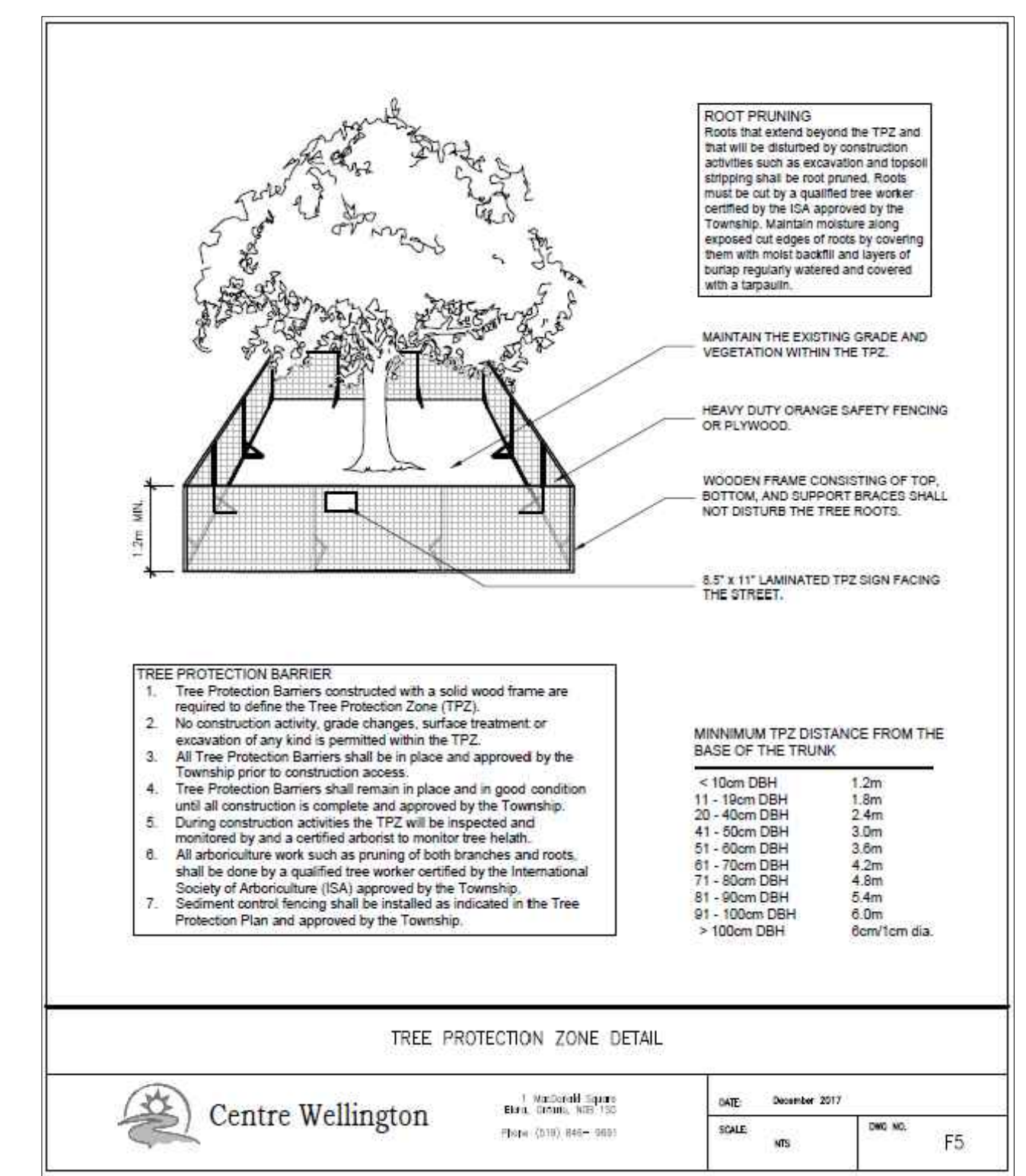

2 TREE PROTECTION DETAIL
CENTRE WELLINGTON STANDARD

LEGEND

- EXISTING DECIDUOUS TREE TO REMAIN
- EXISTING DECIDUOUS TREE TO BE REMOVED (REFER TO ARBORIST REPORT)
- EXISTING CONIFEROUS TREE TO REMAIN
- EXISTING CONIFEROUS TREE TO BE REMOVED (REFER TO ARBORIST REPORT)
- TREE IDENTIFICATION KEY (TREES TO BE RETAINED)
- TREE IDENTIFICATION KEY (TREES TO BE REMOVED)
- TREE PROTECTION FENCING PER TOWN OF ELORA STANDARDS

- GENERAL NOTES**
- Do not scale the drawings. All dimensions are in millimetres unless noted otherwise.
 - This drawing is to be read in conjunction with the project site plan, landscape plan, and engineering plan.
 - The tree inventory includes assessment of trees >10cm DBH. The trees have been assessed based on species, size and condition.
 - The contractor shall check and verify all existing and proposed grading and conditions on the project and immediately report any discrepancies to the consultant before proceeding with any removals.
 - The contractor is to be aware of all existing and proposed services and utilities. The contractor is responsible for having all underground services and utility lines staked by each agency having jurisdiction prior to commencing work.
 - This drawing is to be used for development approval only.
 - Do not leave any holes open overnight.
 - Keep area outside construction zone clean and useable by others at all times. Contractor shall thoroughly clean areas surrounding the construction zone at the end of each work day.
 - Contractor to make good any and all damages outside of the development area that may occur as a result of tree removals at no extra cost.
 - This drawing is Copyright MHBC, 2023.

2.	MARCH 22, 2023	ISSUED FOR SPA	NV
1.	JULY 18, 2022	ISSUED FOR SPA	NV
REVISION NO.	DATE	ISSUED / REVISION	BY

MHBC PLANNING URBAN DESIGN & LANDSCAPE ARCHITECTURE
230-7050 WESTON ROAD WOODBRIDGE, ON, L4L 6G7 | P: 905.761.5588 F: 905.761.5589 | WWW.MHBCPLAN.COM

STAMP

DATE JULY 2022

DRAWN BY NV

PLAN SCALE 1:200

FILE NO. ---

CHECKED BY N.M.

OTHER

PROJECT

19 MILL STREET EAST
ELORA, ONTARIO

FILE NAME TREE INVENTORY, PROTECTION, AND REMOVALS

DWG NO. TI-1